



**BUSINESS OF THE CITY COUNCIL
CITY OF MERCER ISLAND, WA**

**AB 3456
February 7, 2000
Regular Business**

MERCERDALE PARK MASTER PLAN	Proposed Council Action: Approve Master Plan. Modify CIP Project Scope.
------------------------------------	---

DEPARTMENT OF	Park and Recreation (Gary Feroglia)
COUNCIL LIAISON	n/a
EXHIBITS	1. Mercerdale Park Master Plan 2000 2. Mercerdale Park Repairs CIP Budget Project Sheet
APPROVED BY CITY MANAGER	<i>Rich Conrad</i> 2-17-00

AMOUNT OF EXPENDITURE	\$	20,000
AMOUNT BUDGETED	\$	20,000
APPROPRIATION REQUIRED	\$	0

SUMMARY

The 1999-2000 Council-adopted Capital Improvement Program included improvements to Mercerdale Park. Project No. WP907R provided for a BMX bike course, resurfacing the plaza at Bicentennial Park, and making drainage repairs at south side of park with any of the remaining \$20,000 budgeted for the project. These improvements are all consistent with the 1989 adopted Mercerdale Park Master Plan. During presentation and adoption in the 1999-2000 Biennial Budget, the City Council requested that staff return to the Council with a revised park master plan prior to implementing the improvements. This was requested so that past or future departures from the plan could be reviewed and understood in light of all existing park improvements. This agenda item is intended to comply with the Council's request as well as to modify the approved CIP project to incorporate implementation of the proposed Children's Play Area and Wetland Garden.

Mercerdale Park Master Plan

The original master plan was developed by MacLeod Reckord Landscape Architects and was approved by the Council in 1989. The plan was based on the recommendations of the Mercerdale Task Force and established by the City Council on June 13, 1988 to:

Instruct the City Manager, working with the Park & Community Activities Board, to develop alternative concept designs consistent with the commitment to retain Mercerdale as public land and develop it as a naturally landscaped park with open space, trails, an area for people to enjoy as a quiet spot, some play areas for children and a public plaza as a focal point that invites interaction with the Central Business District. The planning effort should include the athletic field use of the fields, a short-term or interim use and not preclude future use of the site for elderly housing, senior or community centers (should the need arise) or current use of the site by the thrift shop and recycling center. **[CITY COUNCIL MOTION OF JUNE 13, 1988]**

The City has lived up to the intent of the motion with the development of the park facilities at the south end of the business district. The native garden, adjacent to the recycling center and the skateboard facility are two significant additions to the park since its' dedication on November 2, 1990.

The revised master plan reflects four noticeable changes from the 1989 Plan: 1) informal amphitheater eliminated; 2) children's play area moved from where the native garden has been installed; 3) formal garden along SE 32nd Street eliminated; and 4) the development of a wetland garden. The differences between the adopted 1989 master plan and the proposed "Plan 2000" are illustrated in Exhibit 1. A detailed visual presentation of the proposed (revised) Master Plan itself will be made at the Council meeting. The proposed revisions will provide additional amenities that will enhance public enjoyment of the park, maintaining the integrity of the park and providing a plan that can be implemented in the over the next several years.

CIP Project Scope Modification – Children's Play Area & Wetland Garden

The plan is designed to improve the infrastructure of the park. The most visually significant improvement is the development of a children's play area and wetland garden. The Mercer Island Preschool Association addressed the City Council on December 6, 1999, supporting the development of the children's play area. The association representative informed the Council that they have made this a "Millennium Pride Project" and plan to raise sufficient funds to complete the development of this play area for the community.

Staff has been working with the Preschool Association in the design and development of this play area. Upon Council's approval to modify the existing CIP project, staff will develop detailed plans and cost estimates for that portion of the project. Following design, staff will seek Design Commission review and approval. Once that is accomplished and staff has obtained an indication from the Preschool Association that sufficient funds have been raised to implement the project, staff will return to the Council to report on the outcome of the design and fundraising processes and seek authorization to proceed.

RECOMMENDATION

Park & Recreation Director

MOVE TO: (1) Approve the Mercerdale Park Master Plan as presented and authorize staff to proceed with the proposed improvements as approved in the 1999-2000 budget.

(2) Amend the 1999-2000 Capital Improvement Program Budget Project ID #WP907R to include the Children's Play Area and Wetland Garden and support the Mercer Island Preschool Association's "Millennium Pride Project" to develop the children's play area.

Alternative: Modify master plan.

YOUTH & FAMILY SERVICES THRIFT SHOP
BUILDING

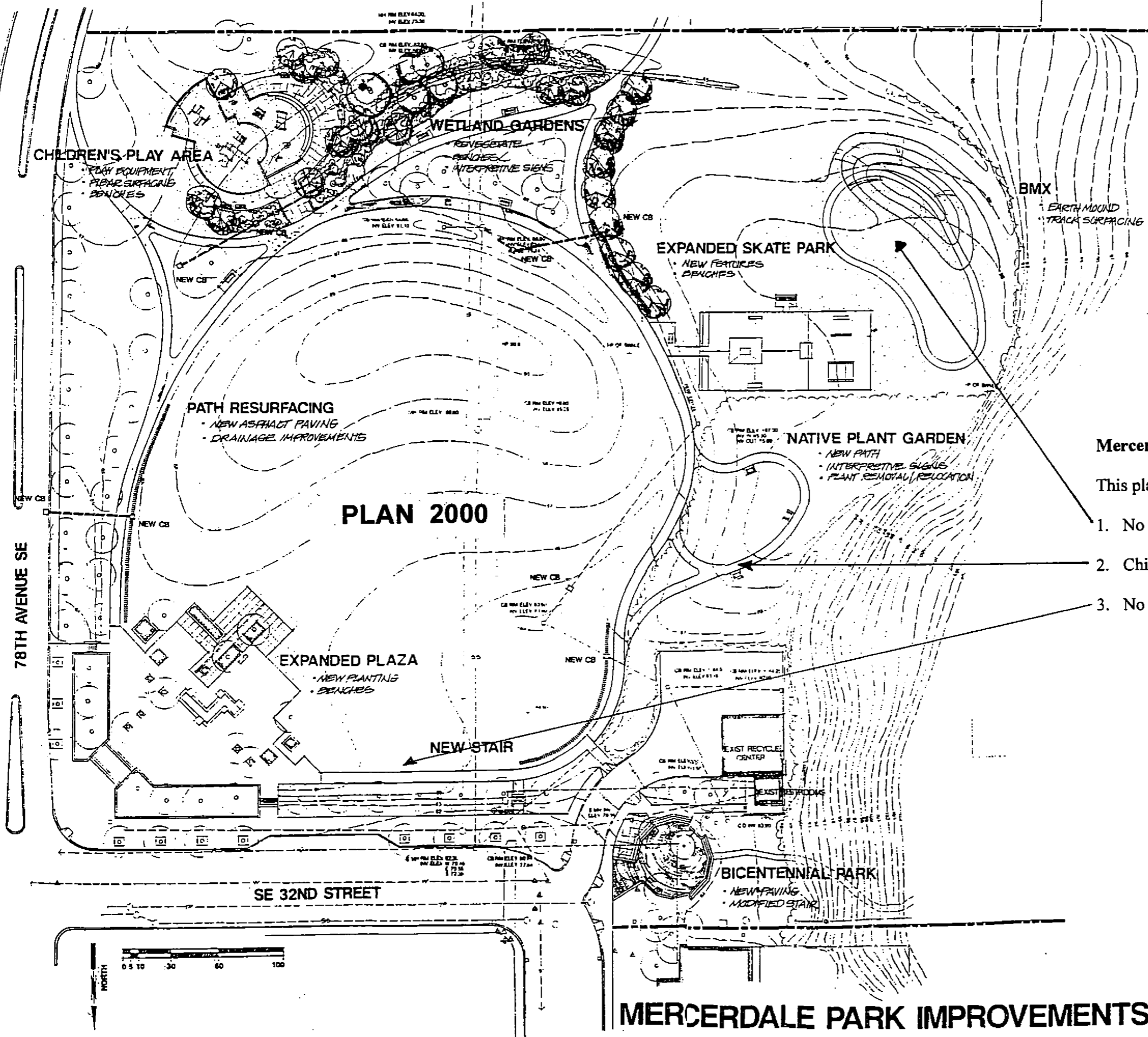

1989
Mercerdale Park Master Plan

This plan differs from Plan 2000 in the following areas

1. No Informal Amphitheater
2. Children's Play Area moved from where the native garden has been installed
3. No Formal Garden along SE 32nd

MERCERDALE PARK IMPROVEMENTS

Mercedale Park Repairs

Project ID	WP907R
Project Description	Resurface the Bicentennial Plaza and construct a BMX bike course behind the existing skateboard facility in 1999. Drainage improvements in the year 2002. Additional drainage, path resurfacing and skateboard improvement are projected for 2004. The BMX area will require additional operating funds to routinely inspect and maintain the facility.
Business Need	The original Bicentennial Plaza brick pavers are failing and need to be replaced. There is high interest from community youth for a BMX bike course that complements the existing skateboard facility. Drainage in the park is inadequate and compounded by impervious native soils.
Existing Conditions	The Bicentennial Plaza brick pavers are cracking and settling creating trip hazards and drainage problems. There is currently no BMX bike facility provided in the park system. Poor drainage restricts full use of the park creating an undesirable accumulation of water in low areas and higher areas sheet water creating turf dry-outs.
Prior Council Review	Study Session - 7/20/98.

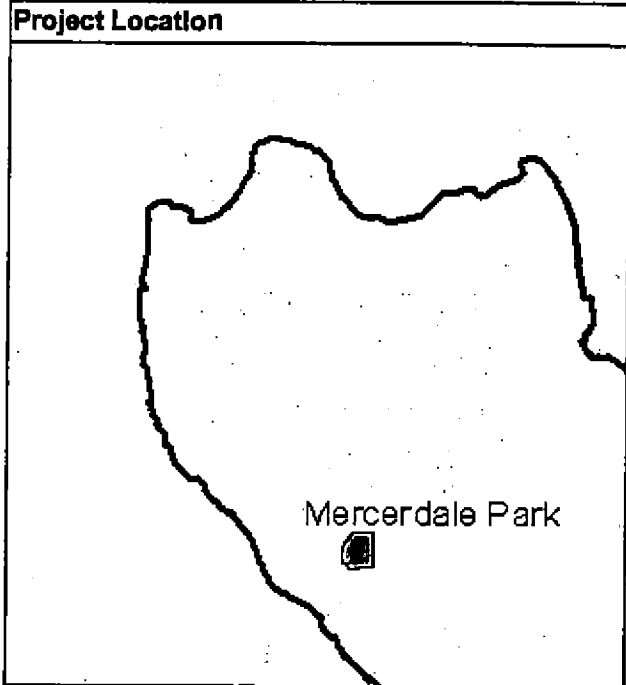

Required Resources (\$1,000's)

CIP Funds - Expenditures								
Description	1998	1999	2000	2001	2002	2003	2004	1999-2004 Total
Parks Repairs	0	20	0	0	40	0	40	100
Total Expenditures	\$0	\$20	\$0	\$0	\$40	\$0	\$40	\$100

CIP Funds - Revenues								
Description	1998	1999	2000	2001	2002	2003	2004	1999-2004 Total
REET 2	0	20	0	0	40	0	40	100
Total Revenues	\$0	\$20	\$0	\$0	\$40	\$0	\$40	\$100

Impacts on Operations and Maintenance	1998	1999	2000	2001	2002	2003	2004	Total
Labor	0	3	3	3	3	3	3	18
Net Impacts	\$0	\$3	\$3	\$3	\$3	\$3	\$3	\$18