

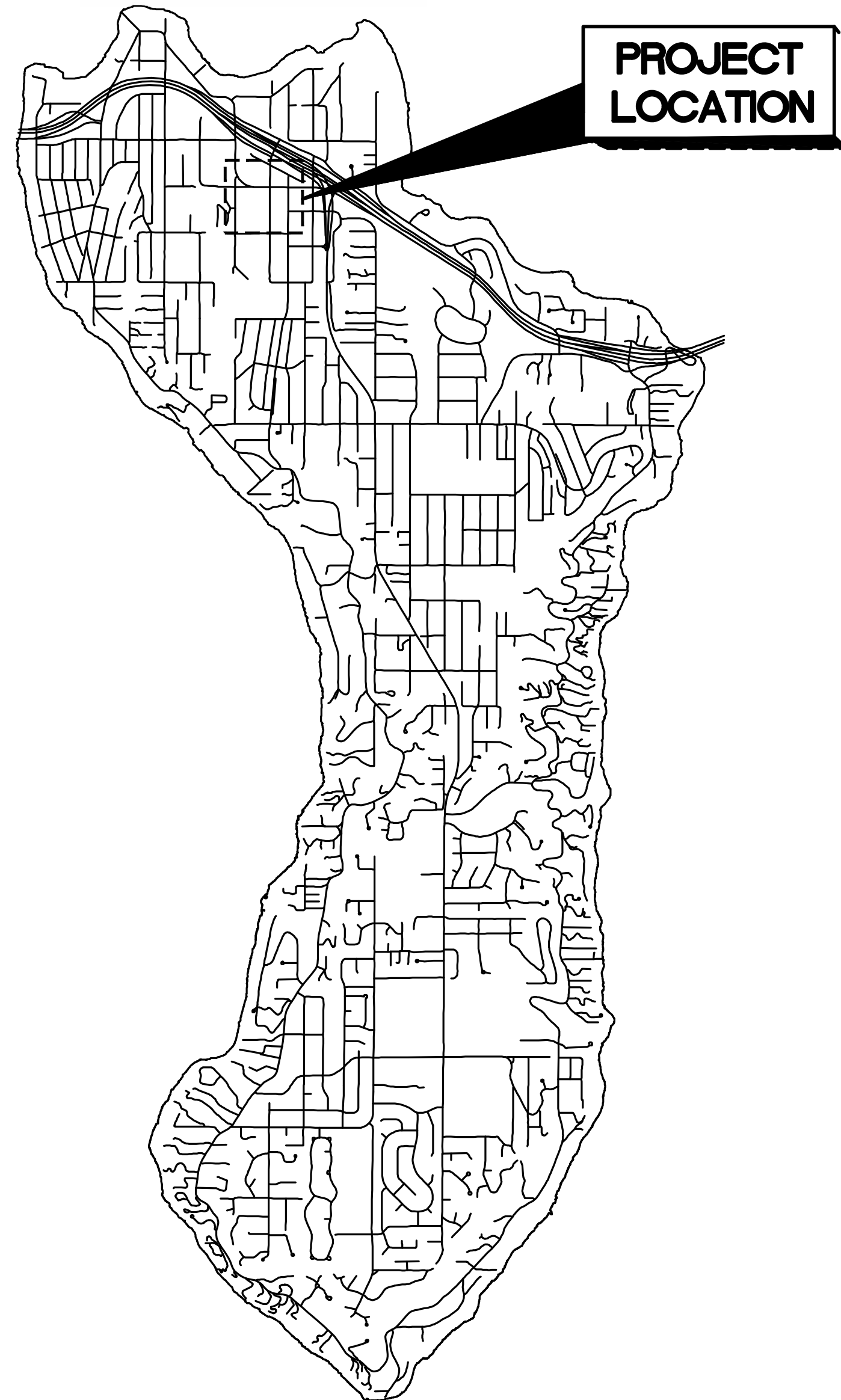

# CITY OF MERCER ISLAND, WA

## ADA TRANSITION PLAN IMPLEMENTATION

### PROJECT NO: SP0118



**VICINITY MAP**  
NTS

## MAY 2024

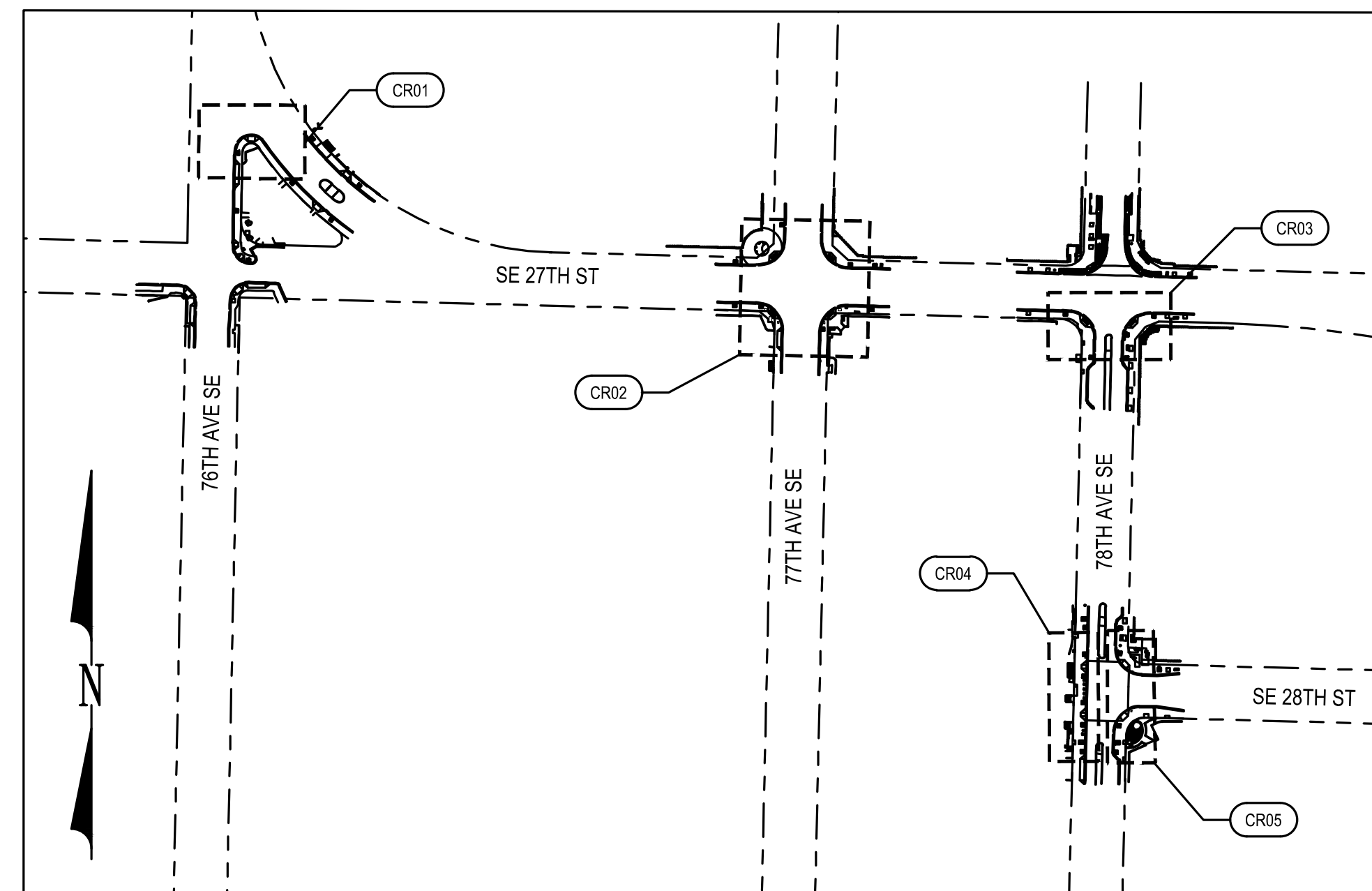

**SITE LOCATION**  
NTS

| SHEET INDEX |           |                                  |
|-------------|-----------|----------------------------------|
| SHEET       | SHEET NO. | SHEET TITLE                      |
| CV01        | 1         | COVER SHEET & SHEET INDEX        |
| GN01        | 2         | NOTES, LEGEND, AND ABBREVIATIONS |
| CR01-CR05   | 3-7       | CURB RAMP PLANS                  |
| CD01        | 8         | DETAILS                          |

| NO. | DATE | BY | CHD. | APPR. | REVISION |
|-----|------|----|------|-------|----------|
|     |      |    |      |       |          |

|                    |                    |
|--------------------|--------------------|
| DRAWN BY<br>MV     | DESIGNED BY<br>VSB |
| CHECKED BY<br>JRG  | APPROVED BY<br>PDS |
| DATE<br>05/15/2024 |                    |
| JOB No. : 2300452  |                    |

**CALL TWO BUSINESS DAYS BEFORE YOU DIG**  
1-800-424-5555

SCALE:  
AS SHOWN

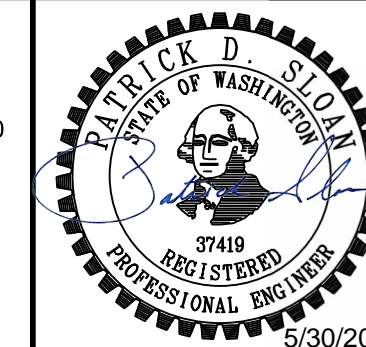

ADA TRANSITION PLAN IMPLEMENTATION  
MERCER ISLAND, WA

**COVER SHEET & INDEX**

SHEET

**CV01**

**ABBREVIATIONS:**

|          |                               |          |                                   |
|----------|-------------------------------|----------|-----------------------------------|
| AC       | ASPHALT CONCRETE              | NE       | NORTHEAST                         |
| ACP      | ASPHALT CONCRETE PAVEMENT     | NIC      | NOT IN CONTRACT                   |
| AP       | ANGLE POINT                   | NO.      | NUMBER                            |
| APPROX   | APPROXIMATE                   | NTS      | NOT TO SCALE                      |
| AVE      | AVENUE                        | OC       | ON CENTER                         |
| BBOC     | BOTTOM OF BACK OF CURB        | OD       | OUTSIDE DIAMETER                  |
| BLDG     | BUILDING                      | PC       | POINT OF CURVATURE                |
| CB       | CATCH BASIN                   | PCC      | POINT OF COMPOUND CURVE           |
| €        | CENTERLINE                    | PCCP     | PORTLAND CEMENT CONCRETE PAVEMENT |
| CL       | CLASS                         | P.E.     | PROFESSIONAL ENGINEER             |
| CONC     | CONCRETE                      | PG       | PROPOSED GRADE                    |
| CONT'D   | CONTINUED                     | PO       | POST OFFICE                       |
| CSBC     | CRUSHED SURFACING BASE COURSE | POB      | POINT OF BEGINNING                |
| CSTC     | CRUSHED SURFACING TOP COURSE  | POE      | POINT OF END                      |
| CW       | CONCRETE WALKWAY              | PK       | SURVEY CONTROL NAIL               |
| DIA      | DIAMETER                      | PL       | PLACE                             |
| DI       | DUCTILE IRON                  | PT       | POINT OF TANGENCY                 |
| DWG      | DRAWING                       | PVI      | POINT OF VERTICAL INTERSECT       |
| DWY      | DRIVEWAY                      | PVMT     | PAVEMENT                          |
| E        | EAST, EASTING                 | QTY      | QUANTITY                          |
| EG       | EXISTING GRADE                | R        | RADIUS, RANGE                     |
| EL       | ELEVATION                     | RD       | ROAD                              |
| EW       | EACH WAY                      | ROW, R/W | RIGHT-OF-WAY                      |
| EX/EXIST | EXISTING                      | RT       | RIGHT                             |
| ESMT     | EASEMENT                      | S        | SOUTH                             |
| FG       | FINISHED GRADE                | SD       | STORM DRAIN                       |
| FL       | FLOW LINE                     | SEC      | SECTION                           |
| FOC      | FACE OF CURB                  | SHT      | SHEET                             |
| FT       | FOOT/FEET                     | SPEC     | SPECIFICATIONS                    |
| GAL      | GALLON                        | ST       | STREET                            |
| HMA      | HOT MIXED ASPHALT             | STA      | STATION                           |
| HT       | HEIGHT                        | STD      | STANDARD                          |
| IE       | INVERT ELEVATION              | SW       | SIDEWALK                          |
| H, HORIZ | HORIZONTAL                    | T        | TOWNSHIP                          |
| LF       | LINEAR FEET                   | TC       | TOP OF CURB                       |
| LSCAPE   | LANDSCAPE                     | TEMP     | TEMPORARY                         |
| LT       | LEFT                          | TYP      | TYPICAL                           |
| MAX      | MAXIMUM                       | V, VERT  | VERTICAL                          |
| MIN      | MINIMUM                       | W        | WEST/WATER                        |
| MJ       | MECHANICAL JOINT              | W/       | WITH                              |
| MH       | MAINTENANCE HOLE              | WQ       | WATER QUALITY                     |
| N        | NORTH, NORTHING               | WM       | WATER METER                       |
| N/A      | NOT APPLICABLE                |          |                                   |

**HORIZONTAL AND VERTICAL CONTROL:**

**BASIS OF MERIDIAN:**  
WASHINGTON STATE PLANE COORDINATES, NORTH ZONE 4601, NAD 83/11. PER WSDOT CONTROL POINT ROANOKE (6477).

**VERTICAL DATUM:**  
NAVD 88, CONTRACTOR TO VERIFY VERTICAL DATUM WITH TIES TO LOCAL SITE CONTROL AND SURFACE FEATURES.

**UTILITY NOTE:**  
UTILITIES SHOWN HEREON ARE PER KPFF SITE SURVEY OF SURFACE FEATURES. UTILITIES SHOULD BE CONSIDERED APPROXIMATE ONLY AND VERIFIED PRIOR TO CONSTRUCTION.

**METHOD OF SURVEY:**  
CONTROL SURVEY PERFORMED USING RTK METHODS WITH THE USE OF TOPCON HIPER VR GPS RECEIVERS. TOPOGRAPHIC AND SUPPLEMENTAL CONTROL PERFORMED USING CONVENTIONAL METHODS WITH THE USE OF TOPCON GT 503 ROBOTIC TOTAL STATION.

THE WORK PERFORMED DURING THE COURSE OF THIS SURVEY MEETS OR EXCEEDS THE STANDARDS AS SET FORTH IN WAC 332-130-090.

SURVEY WORK COMPLETED IN SEPTEMBER OF 2023.

| Point | Northing   | Easting     | Elevation | Description |
|-------|------------|-------------|-----------|-------------|
| 107   | 217404.200 | 1293878.172 | 96.27     | SET MN      |
| 109   | 217220.376 | 1293850.961 | 107.15    | SET MN      |
| 113   | 217127.216 | 1294495.856 | 82.87     | SET MN      |
| 115   | 217143.653 | 1294584.297 | 83.23     | SET MN      |
| 117   | 217138.100 | 1294833.597 | 90.93     | SET MN      |
| 123   | 216676.519 | 1294887.769 | 91.99     | SET MN      |
| 126   | 216291.555 | 1294882.291 | 89.49     | SET MN      |
| 130   | 216108.518 | 1294876.903 | 87.94     | SET MN      |
| 139   | 216444.277 | 1294537.614 | 82.93     | SET MN      |

**EXISTING LEGEND:**

|  |                                 |
|--|---------------------------------|
|  | FOUND INTERSECTION MONUMENT     |
|  | KPFF CONTROL POINT              |
|  | TELEPHONE MAINTENANCE HOLE      |
|  | TELEPHONE VAULT                 |
|  | TELEPHONE PEDESTAL              |
|  | POWER VAULT                     |
|  | POWER TRANSFORMER               |
|  | POWER METER                     |
|  | LIGHT STANDARD                  |
|  | STREET LIGHT                    |
|  | ELECTRICAL JUNCTION BOX         |
|  | STORM DRAIN MAINTENANCE HOLE    |
|  | STORM DRAIN CATCH BASIN         |
|  | CLEANOUT                        |
|  | SANITARY SEWER MAINTENANCE HOLE |
|  | POST INDICATOR VALVE            |
|  | WATER VAULT                     |
|  | WATER METER                     |
|  | WATER VALVE                     |
|  | IRRIGATION CONTROL VALVE        |
|  | FIRE HYDRANT                    |
|  | WELL                            |
|  | GAS METER                       |
|  | GAS VALVE                       |
|  | BOLLARD                         |
|  | POST                            |
|  | LARGE ROCK                      |
|  | SIGN AS NOTED                   |
|  | MAILBOX AS NOTED                |
|  | CONIFER TREE AS NOTED           |
|  | DECIDUOUS TREE AS NOTED         |
|  | EDGE OF LANDSCAPE               |
|  | BUILDING OVERHANG               |
|  | EDGE OF PAVEMENT                |
|  | EDGE OF GRAVEL                  |
|  | ROAD CENTERLINE                 |
|  | ROAD RIGHT-OF-WAY               |
|  | CONCRETE HATCH                  |
|  | BUILDING HATCH                  |
|  | BRICK HATCH                     |
|  | DECORATIVE CONCRETE HATCH       |
|  | NO SLIP PADS                    |

**GENERAL NOTES:**

- CONTRACTOR SHALL SEQUENCE REMOVAL OF EXISTING FEATURES WITH CONSTRUCTION OF NEW SIDEWALK AND ROADWAY ELEMENTS TO MINIMIZE IMPACTS TO PROPERTY OWNERS, PEDESTRIANS, TRAFFIC FLOW, AND THE ENVIRONMENT.
- CONTRACTOR SHALL PROTECT ALL ABOVE AND BELOW GROUND UTILITIES, IRRIGATION, AND IMPROVEMENTS THAT ARE TO REMAIN.
- CONTRACTOR SHALL PROVIDE AND MAINTAIN TEMPORARY PEDESTRIAN ROUTE AROUND CONSTRUCTION ACTIVITY FOR THE DURATION OF CONSTRUCTION.
- CONTRACTOR SHALL COORDINATE TEMPORARY TRAFFIC CONTROL WITH ADJACENT SOUND TRANSIT SIGNAL WORK IN TOWN CENTER TO MINIMIZE IMPACTS.

**TESC NOTES:**

- CONTRACTOR SHALL FURNISH AND INSTALL INLET PROTECTION IN ALL EXISTING AND NEW CATCH BASINS WITHIN AND ADJACENT TO PROTECT AREA. CONTRACTOR SHALL INSTALL OTHER EROSION CONTROL MEASURES TO MINIMIZE SEDIMENT INTO STREAMS AND STORM DRAINAGE SYSTEMS.

**PROPOSED LEGEND:**

|  |                            |
|--|----------------------------|
|  | CEMENT CONC. SIDEWALK      |
|  | DETECTABLE WARNING SURFACE |
|  | HMA PAVING                 |
|  | MULCHING                   |
|  | BREAK LINE                 |
|  | SAWCUT                     |
|  | RIGHT OF WAY               |
|  | ARC LENGTH                 |

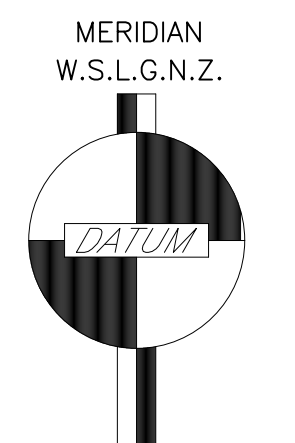

NAD 83/91 NAVD 88

| NO. | DATE | BY | CHD. | APPR. | REVISION |
|-----|------|----|------|-------|----------|
|     |      |    |      |       |          |
|     |      |    |      |       |          |
|     |      |    |      |       |          |
|     |      |    |      |       |          |

|                    |                    |
|--------------------|--------------------|
| DRAWN BY<br>MV     | DESIGNED BY<br>VSB |
| CHECKED BY<br>JRG  | APPROVED BY<br>PDS |
| DATE<br>05/15/2024 |                    |
| JOB No. : 2300452  |                    |

**CALL TWO BUSINESS DAYS BEFORE YOU DIG**  
1-800-424-5555

SCALE:  
AS SHOWN



1601 5th Avenue, Suite 1600  
Seattle, WA 98101  
206.622.5822  
www.kpff.com

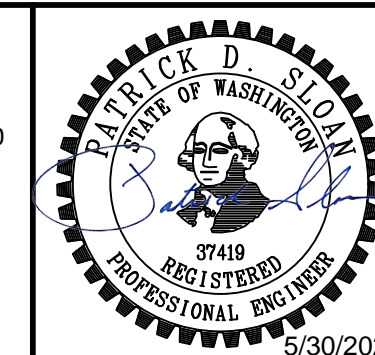

**ADA TRANSITION PLAN IMPLEMENTATION**  
MERCER ISLAND, WA

**NOTES, LEGEND, AND ABBREVIATION**

SHEET

**GN01**







**MEF CODES (\*)**

- 1 RIGHT-OF-WAY AVAILABILITY
- 2 ROADWAY STRUCTURAL CONSTRAINT; WALL, AREAWAY, OR BRIDGE
- 3 ADJACENT DEVELOPED FACILITY
- 4 DRAINAGE
- 5 HISTORIC FEATURE
- 6 EXISTING ROAD/SIDEWALK SLOPED
- 7 EXISTING UTILITY VAULT OR UTILITY STRUCTURE
- 8 (OTHER) DESCRIBE, ADD ANNOTATION

**CURB RAMP SCHEDULE**

|    | RAMP TYPE | MEF CODE |
|----|-----------|----------|
| R8 | (2)       | -        |
| R9 | (2)       | -        |

**GENERAL NOTES**

- 1. ELEVATION CALLOUTS REFER TO BOTTOM OF CURB, UNLESS OTHERWISE NOTED
- 2. ALL NEWLY CONSTRUCTED PEDESTRIAN ACCESS ROUTES INCLUDING SIDEWALK AND CURB RAMPS MUST MEET CURRENT ADA GUIDELINES (PROWAG 2023) TO THE MAXIMUM EXTENT FEASIBLE
- 3. THE CONTRACTOR MUST NOTIFY THE ENGINEER IF A CURB RAMP CANNOT BE CONSTRUCTED PER THE DRAWINGS, RESULTING IN NON-COMPLIANT SLOPES AND/OR DIMENSIONS. THE ENGINEER MUST APPROVE THE NEW CURB RAMP LAYOUT PRIOR TO INSTALLING THE CURB RAMP
- 4. ALL CURB HEIGHTS SHALL BE 6" UNLESS OTHERWISE NOTED.
- 5. ALL TRAFFIC SIGNAL POLES AND LUMINAIRE POLES SHALL BE PROTECTED IN PLACE.
- 6. CONTRACTOR SHALL DELIVER SALVAGED ITEMS TO MERCER ISLAND CITY MAINTENANCE DEPARTMENT, 9601 SE 36TH STREET, MERCER ISLAND, WA 98040.
- 7. ALL CURB AND GUTTER NOT CALLED OUT FOR REPLACEMENT SHALL BE PROTECTED IN PLACE.

**CONSTRUCTION NOTES**

- (1) CONSTRUCT PARALLEL CURB RAMP IN ACCORDANCE WITH WSDOT STD PLAN F-40.12.
- (2) CONSTRUCT PERPENDICULAR CURB RAMP IN ACCORDANCE WITH WSDOT STD PLAN F-40.15.
- (3) CONSTRUCT SCORED CEMENT CONC. SIDEWALK IN ACCORDANCE WITH DETAIL 2/CD01 AND DETAIL 3/CD01.
- (4) CONSTRUCT FULL DEPTH PAVEMENT RESTORATION IN ACCORDANCE WITH DETAIL 1/CD01.
- (5) CONSTRUCT CEMENT CONC. CURB AND GUTTER IN ACCORDANCE WITH WSDOT STD PLAN F-10.12.
- (6) CONSTRUCT CEMENT CONC. PEDESTRIAN CURB IN ACCORDANCE WITH WSDOT STD PLAN F-10.12.
- (7) INSTALL SALVAGED BENCH IN COORDINATION WITH RESIDENT ENGINEER.
- (8) PROTECT IN PLACE EXISTING SIGNAL POLE AND GROUT PAD.
- (9) PROTECT IN PLACE EXISTING LIGHT FIXTURE AND BRICK INLAYS.
- (10) INSTALL NEW D3-1 STREET NAME SIGNS ON NEW SB-1 SUPPORT 2.5" PSST IN ACCORDANCE WITH WSDOT STD PLAN G-24.40.
- (11) ADJUST MANHOLE TO FINISHED GRADE.
- (12) ADJUST CATCH BASIN TO FINISHED GRADE.
- (13) ADJUST VALVE BOX TO FINISHED GRADE.
- (14) ADJUST VAULT/JUNCTION BOX TO FINISHED GRADE.
- (15) INSTALL SALVAGED SIGN ON NEW SB-1 SUPPORT 2.5" PSST IN ACCORDANCE WITH WSDOT STD PLAN G-24.40.
- (16) INSTALL ROOT BARRIER IN ACCORDANCE WITH DETAIL 5/CD01 AND CONTRACT SPECIFICATIONS.

**SITE PREP NOTES**

- (1) REMOVE CEMENT CONC. CURB AND GUTTER.
- (2) REMOVE CEMENT CONC. SIDEWALK.
- (3) ROADWAY EXCAVATION INCL. HAUL.
- (4) REMOVE EXISTING SIGN POST AND SALVAGE EXISTING SIGN.
- (5) REMOVE BOLLARD.
- (6) REMOVE AND SALVAGE EXISTING BENCH.

MATCHLINE - SEE LEFT

MATCHLINE - SEE RIGHT

**R8: 78TH AVE SE & SE 28TH ST - SW**

**R9: 78TH AVE SE & SE 28TH ST - SW**

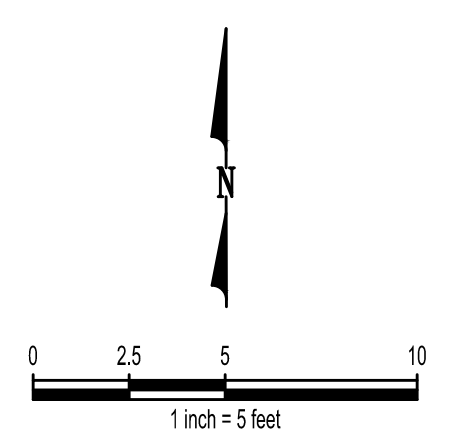
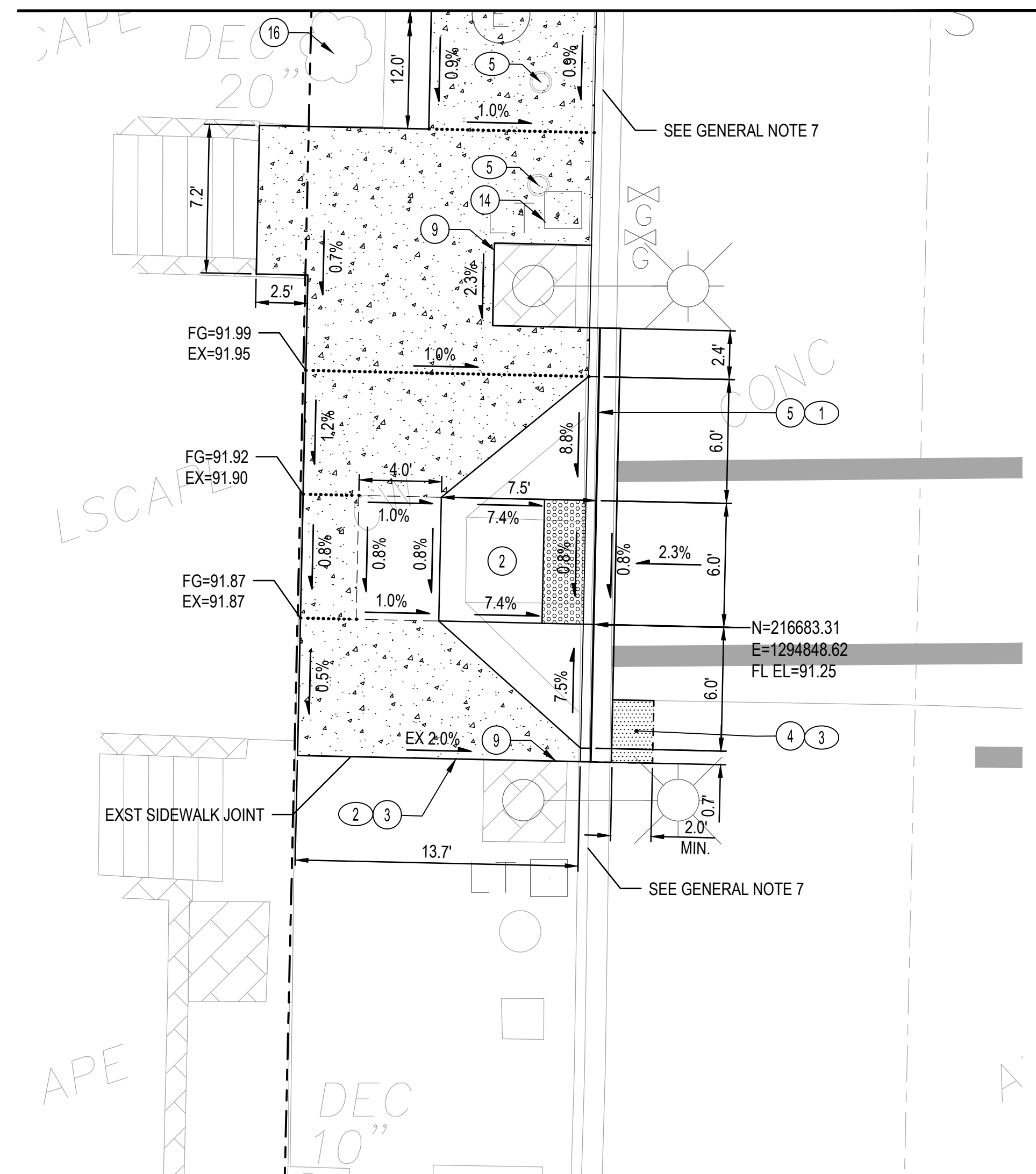
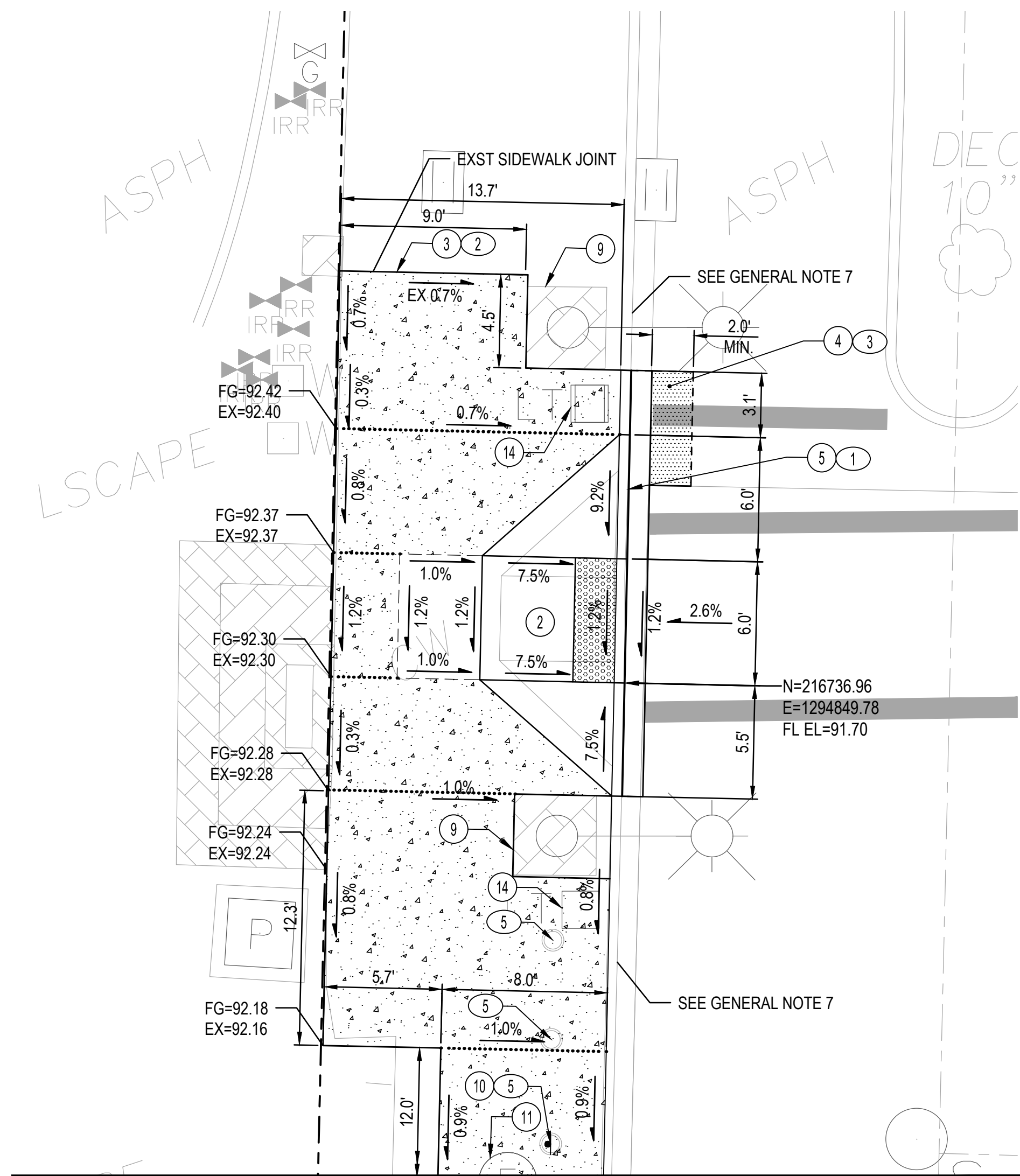

| NO. | DATE | BY | CHD. | APPR. | REVISION |
|-----|------|----|------|-------|----------|
|     |      |    |      |       |          |

|                    |                    |
|--------------------|--------------------|
| DRAWN BY<br>MV     | DESIGNED BY<br>VSB |
| CHECKED BY<br>JRG  | APPROVED BY<br>PDS |
| DATE<br>05/15/2024 |                    |
| JOB No.: 2300452   |                    |

**CALL TWO BUSINESS DAYS BEFORE YOU DIG**  
1-800-424-5555

SCALE:  
AS SHOWN

**kpff**  
1601 5th Avenue, Suite 1600  
Seattle, WA 98101  
206.622.5822  
www.kpff.com

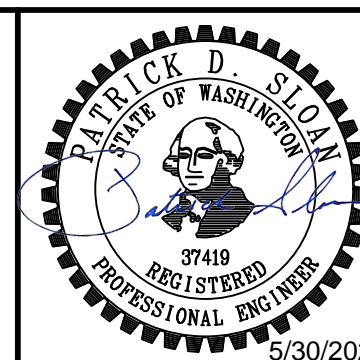

**ADA TRANSITION PLAN IMPLEMENTATION**  
MERCER ISLAND, WA

**CURB RAMP PLANS**

SHEET

**CR04**

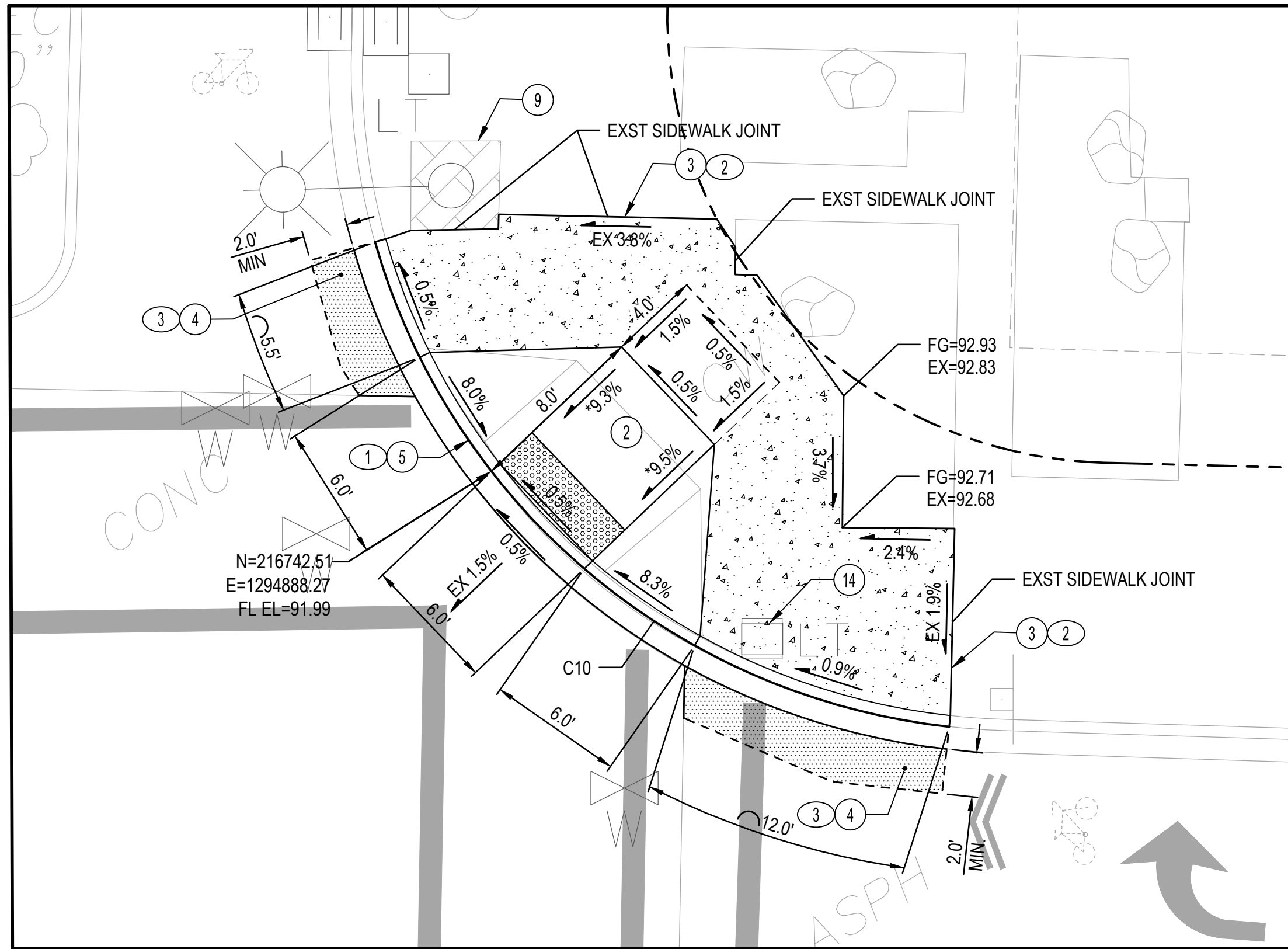

**R10: 78TH AVE SE & SE 28TH ST - NE**

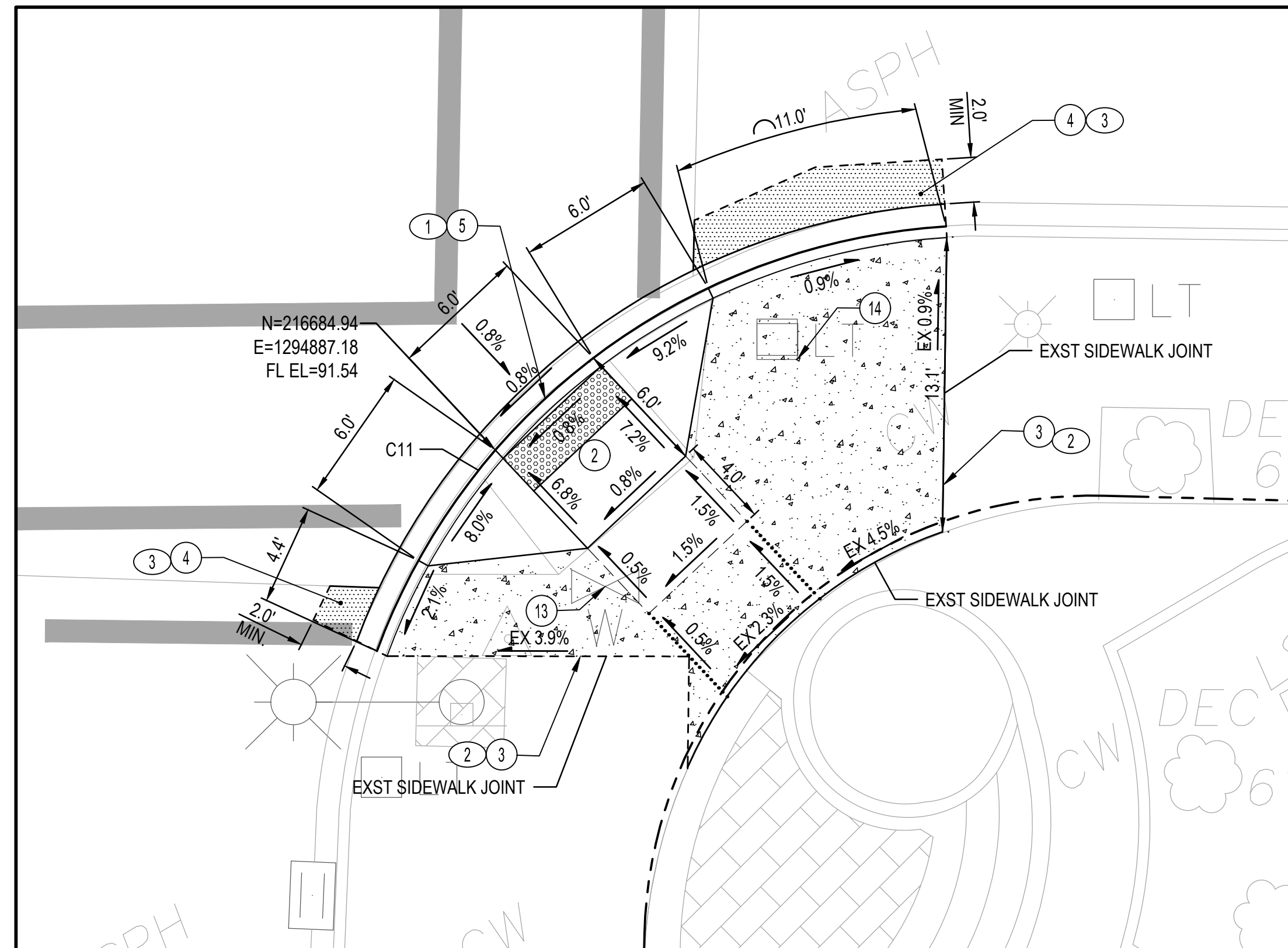

**R11: 78TH AVE SE & SE 28TH ST - SE**

**MEF CODES (\*)**

- 1 RIGHT-OF-WAY AVAILABILITY
- 2 ROADWAY STRUCTURAL CONSTRAINT; WALL, AREAWAY, OR BRIDGE
- 3 ADJACENT DEVELOPED FACILITY
- 4 DRAINAGE
- 5 HISTORIC FEATURE
- 6 EXISTING ROAD/SIDEWALK SLOPED
- 7 EXISTING UTILITY VAULT OR UTILITY STRUCTURE
- 8 (OTHER) DESCRIBE, ADD ANNOTATION

**CURB RAMP SCHEDULE**

|     | RAMP TYPE | MEF CODE |
|-----|-----------|----------|
| R10 | ②         | 5, 6     |
| R11 | ②         | -        |

| CURB RETURN TABLE |       |                             |       |  |
|-------------------|-------|-----------------------------|-------|--|
| CURVE             | POINT | LOCATION                    | EL    | CURVE GEOMETRY                                 |
| C10               | PC    | N:216752.73<br>E:1294883.08 | 91.95 | Δ=67°53'57"<br>T=20.20<br>L=35.55'<br>R=30.00' |
|                   | 1/4   |                             | 91.99 |  |
|                   | 1/2   |                             | 92.03 |  |
|                   | 3/4   |                             | 92.14 |  |
|                   | PT    | N:216731.12<br>E:1294908.69 | 92.18 |  |
| C11               | PC    | N:216694.91<br>E:1294907.29 | 92.15 | Δ=66°11'53"<br>T=18.90<br>L=33.50'<br>R=29.00' |
|                   | 1/4   |                             | 91.78 |  |
|                   | 1/2   |                             | 91.59 |  |
|                   | 3/4   |                             | 91.51 |  |
|                   | PT    | N:216669.02<br>E:1294880.28 | 91.44 |  |

**GENERAL NOTES**

1. ELEVATION CALLOUTS REFER TO BOTTOM OF CURB, UNLESS OTHERWISE NOTED
2. ALL NEWLY CONSTRUCTED PEDESTRIAN ACCESS ROUTES INCLUDING SIDEWALK AND CURB RAMPS MUST MEET CURRENT ADA GUIDELINES (PROWAG 2023) TO THE MAXIMUM EXTENT FEASIBLE
3. THE CONTRACTOR MUST NOTIFY THE ENGINEER IF A CURB RAMP CANNOT BE CONSTRUCTED PER THE DRAWINGS, RESULTING IN NON-COMPLIANT SLOPES AND/OR DIMENSIONS. THE ENGINEER MUST APPROVE THE NEW CURB RAMP LAYOUT PRIOR TO INSTALLING THE CURB RAMP
4. ALL CURB HEIGHTS SHALL BE 6" UNLESS OTHERWISE NOTED.
5. ALL TRAFFIC SIGNAL POLES AND LUMINAIRE POLES SHALL BE PROTECTED IN PLACE.
6. CONTRACTOR SHALL DELIVER SALVAGED ITEMS TO MERCER ISLAND CITY MAINTENANCE DEPARTMENT, 9601 SE 36TH STREET, MERCER ISLAND, WA 98040.
7. ALL CURB AND GUTTER NOT CALLED OUT FOR REPLACEMENT SHALL BE PROTECTED IN PLACE.

**CONSTRUCTION NOTES**

- ① CONSTRUCT PARALLEL CURB RAMP IN ACCORDANCE WITH WSDOT STD PLAN F-40.12.
- ② CONSTRUCT PERPENDICULAR CURB RAMP IN ACCORDANCE WITH WSDOT STD PLAN F-40.15.
- ③ CONSTRUCT SCORED CEMENT CONC. SIDEWALK IN ACCORDANCE WITH DETAIL 2/CD01 AND DETAIL 3/CD01.
- ④ CONSTRUCT FULL DEPTH PAVEMENT RESTORATION IN ACCORDANCE WITH DETAIL 1/CD01.
- ⑤ CONSTRUCT CEMENT CONC. CURB AND GUTTER IN ACCORDANCE WITH WSDOT STD PLAN F-10.12.
- ⑥ CONSTRUCT CEMENT CONC. PEDESTRIAN CURB IN ACCORDANCE WITH WSDOT STD PLAN F-10.12.
- ⑦ INSTALL SALVAGED BENCH IN COORDINATION WITH RESIDENT ENGINEER.
- ⑧ PROTECT IN PLACE EXISTING SIGNAL POLE AND GROUT PAD.
- ⑨ PROTECT IN PLACE EXISTING LIGHT FIXTURE AND BRICK INLAYS.
- ⑩ INSTALL NEW D3-1 STREET NAME SIGNS ON NEW SB-1 SUPPORT 2.5" PSST IN ACCORDANCE WITH WSDOT STD PLAN G-24.40.
- ⑪ ADJUST MANHOLE TO FINISHED GRADE.
- ⑫ ADJUST CATCH BASIN TO FINISHED GRADE.
- ⑬ ADJUST VALVE BOX TO FINISHED GRADE.
- ⑭ ADJUST VAULT/JUNCTION BOX TO FINISHED GRADE.
- ⑮ INSTALL SALVAGED SIGN ON NEW SB-1 SUPPORT 2.5" PSST IN ACCORDANCE WITH WSDOT STD PLAN G-24.40.
- ⑯ INSTALL ROOT BARRIER IN ACCORDANCE WITH DETAIL 5/CD01 AND CONTRACT SPECIFICATIONS.

**SITE PREP NOTES**

- ① REMOVE CEMENT CONC. CURB AND GUTTER.
- ② REMOVE CEMENT CONC. SIDEWALK.
- ③ ROADWAY EXCAVATION INCL. HAUL.
- ④ REMOVE EXISTING SIGN POST AND SALVAGE EXISTING SIGN.
- ⑤ REMOVE BOLLARD.
- ⑥ REMOVE AND SALVAGE EXISTING BENCH.

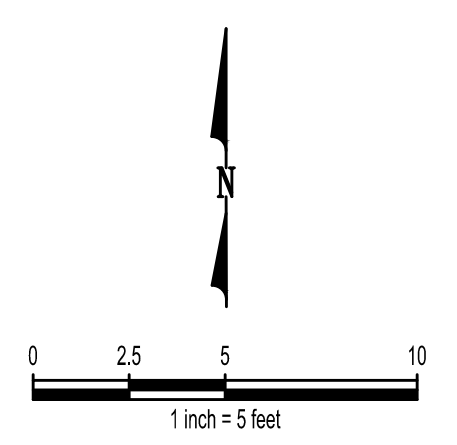

| NO. | DATE | BY | CHD. | APPR. | REVISION |
|-----|------|----|------|-------|----------|
|     |      |    |      |       |          |

|                    |                    |
|--------------------|--------------------|
| DRAWN BY<br>MV     | DESIGNED BY<br>VSB |
| CHECKED BY<br>JRG  | APPROVED BY<br>PDS |
| DATE<br>05/15/2024 |                    |
| JOB No.: 2300452   |                    |

**CALL TWO BUSINESS DAYS BEFORE YOU DIG**  
1-800-424-5555

**kpff**  
1601 5th Avenue, Suite 1600  
Seattle, WA 98101  
206.622.5822  
www.kpff.com

SCALE:  
AS SHOWN

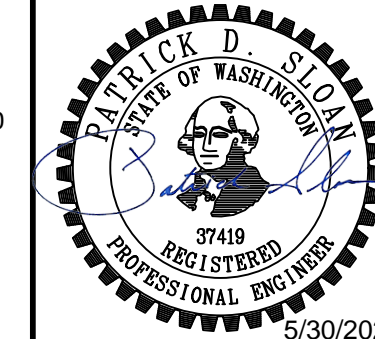

ADA TRANSITION PLAN IMPLEMENTATION  
MERCER ISLAND, WA

**CURB RAMP PLANS**

SHEET

**CR05**

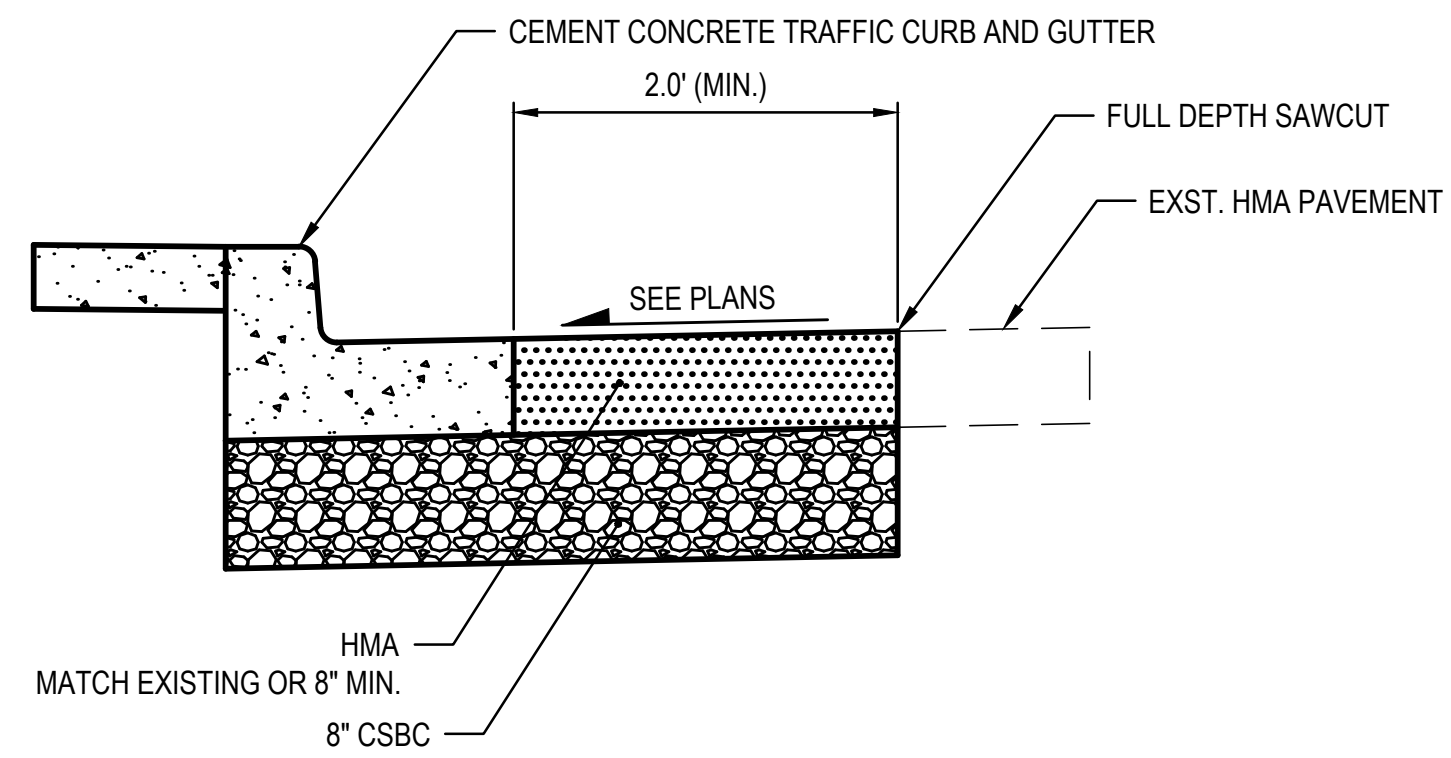

**FULL DEPTH PAVEMENT RESTORATION**

NTS

1

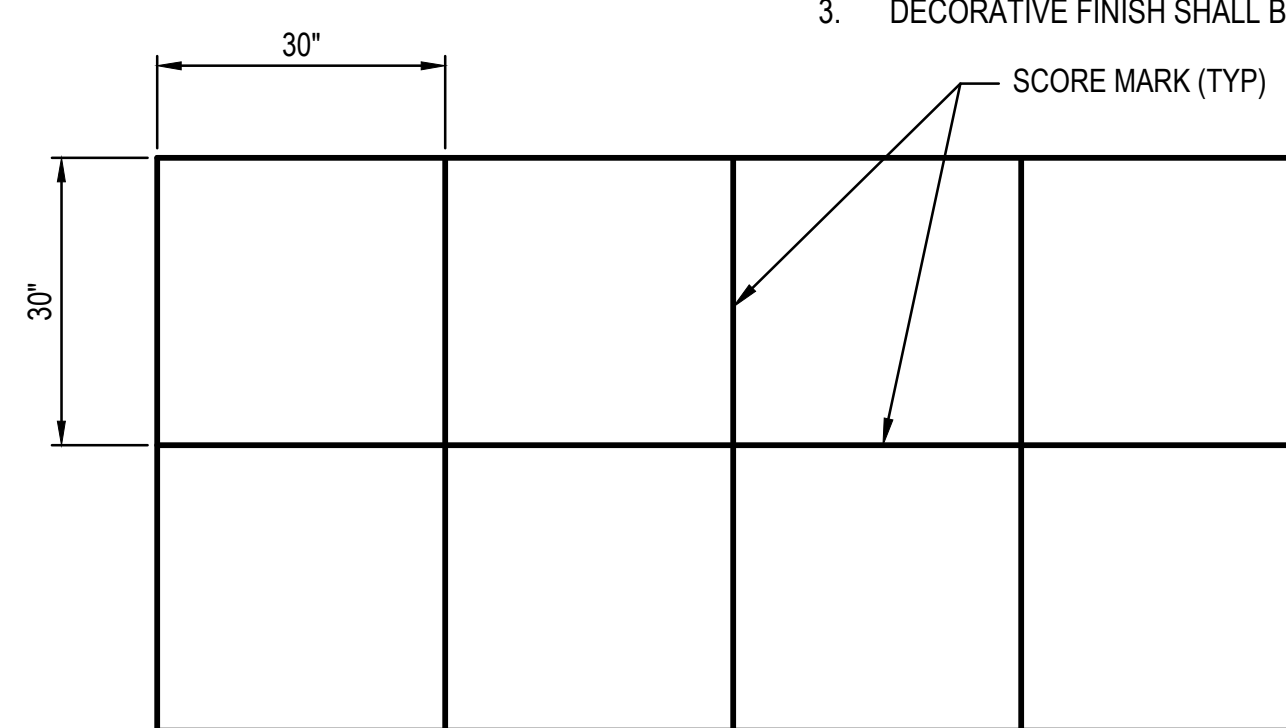

**SCORED CEMENT CONCRETE SIDEWALK FINISH DETAIL**

NTS

2

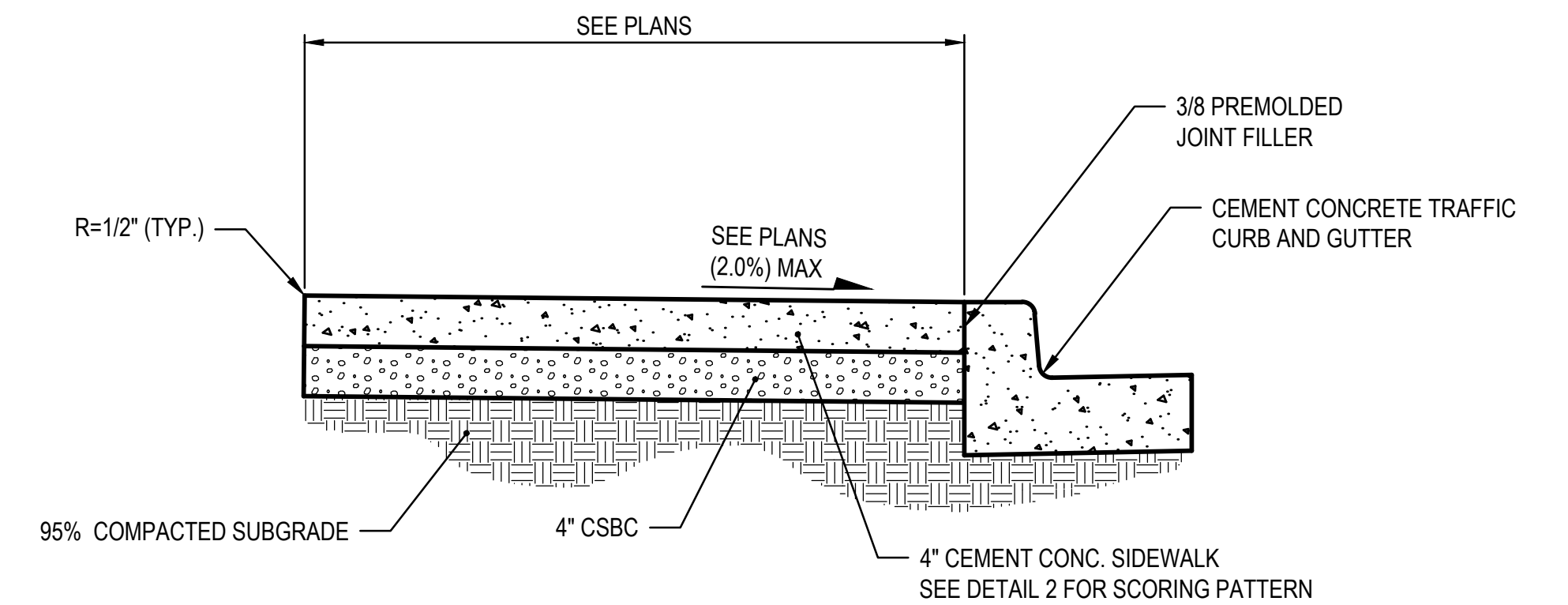

**CEMENT CONCRETE SIDEWALK AND MULCHING**

NTS

3

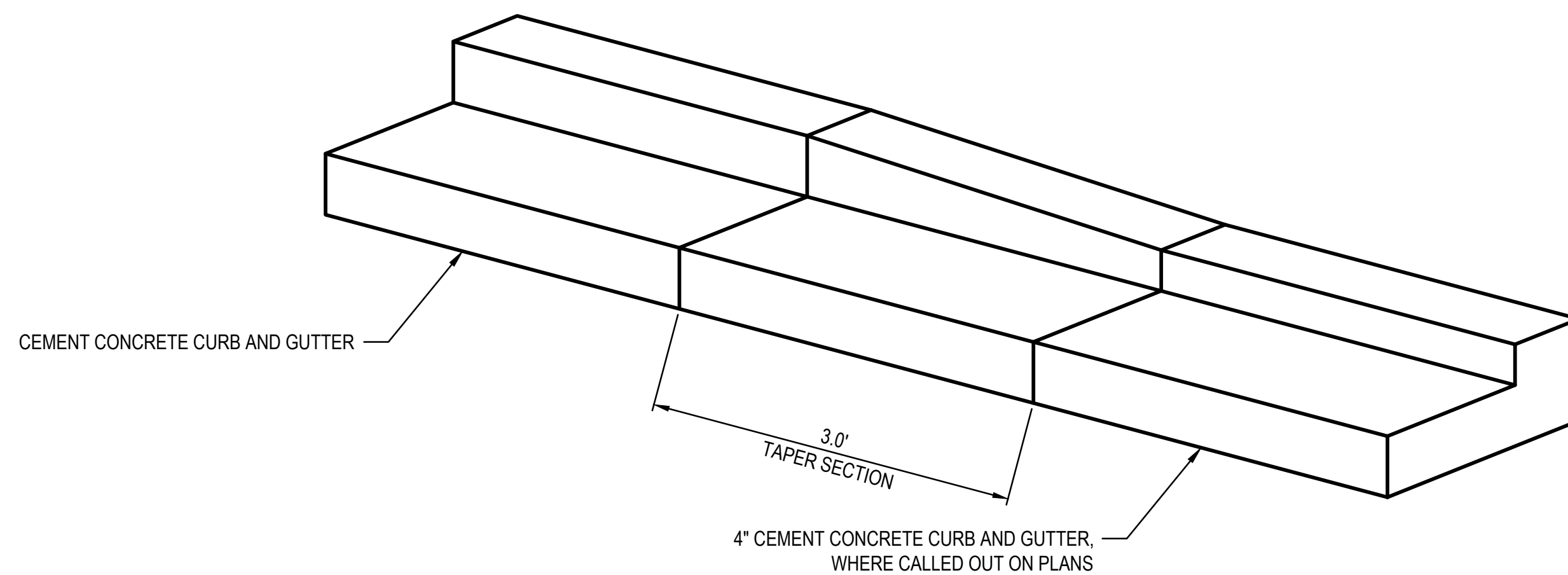

**CURB TAPER**

NTS

4

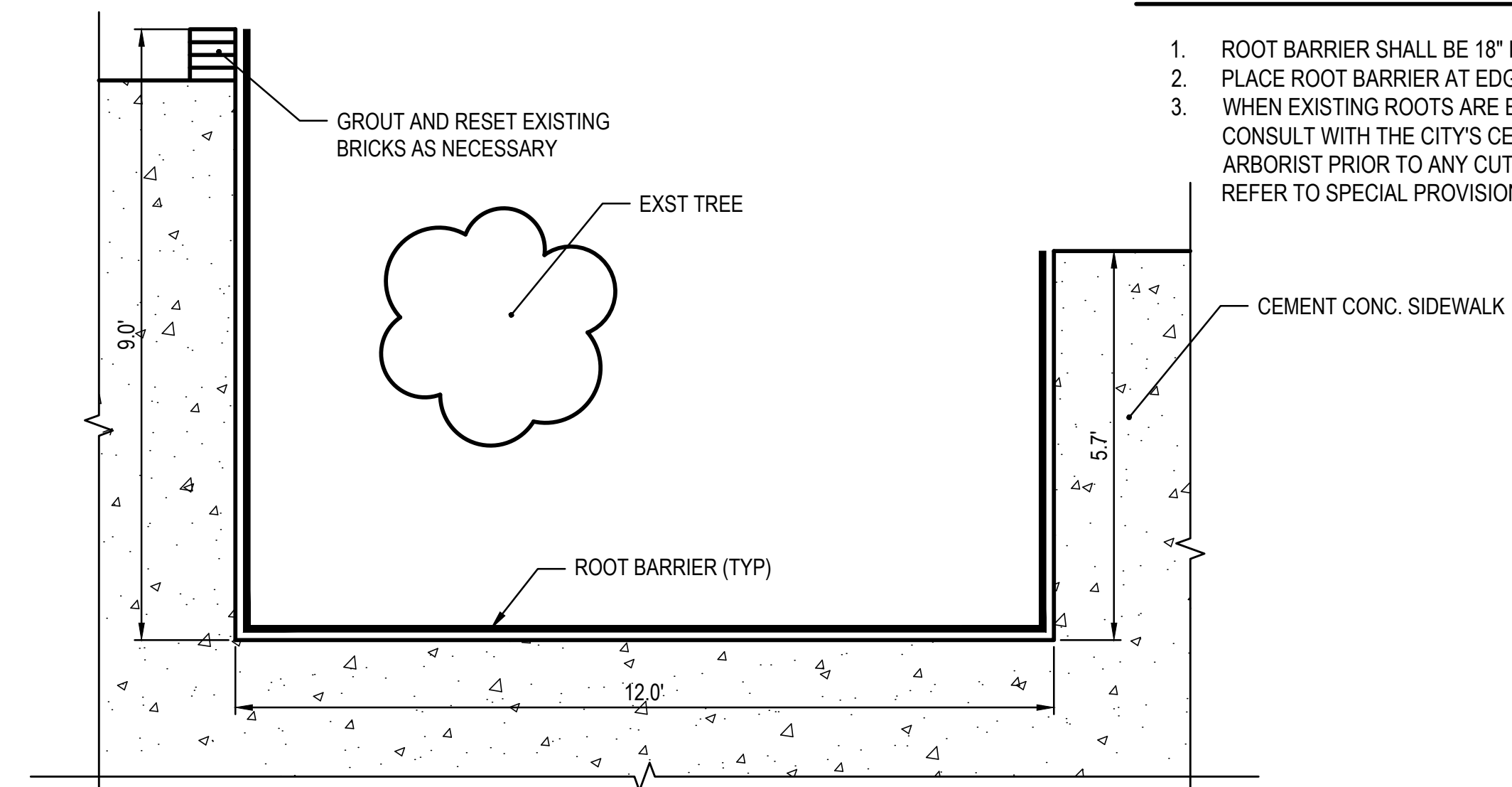

**ROOT BARRIER**

NTS

5

**NOTES:**

- ENGINEER TO APPROVE FINAL DECORATIVE SCORED CEMENT CONCRETE PAVEMENT LAYOUT PRIOR TO INSTALLATION.
- SCORING PATTERN SHALL MATCH ADJACENT, EXISTING TOWN CENTER PATTERN SPACING. DECORATIVE FINISH SHALL BE CONTINUOUS.

**NOTES:**

- ALL SIDEWALK JOINTING SHALL CONFORM TO WSDOT STD. PLAN F-30.10

**NOTES:**

- ROOT BARRIER SHALL BE 18" IN DEPTH
- PLACE ROOT BARRIER AT EDGE OF SIDEWALK
- WHEN EXISTING ROOTS ARE ENCOUNTERED, CONSULT WITH THE CITY'S CERTIFIED ARBORIST PRIOR TO ANY CUTTING OF ROOTS. REFER TO SPECIAL PROVISIONS.

| NO. | DATE | BY | CHD. | APPR. | REVISION |
|-----|------|----|------|-------|----------|
|     |      |    |      |       |          |
|     |      |    |      |       |          |
|     |      |    |      |       |          |

|                    |                    |
|--------------------|--------------------|
| DRAWN BY<br>MV     | DESIGNED BY<br>VSB |
| CHECKED BY<br>JRG  | APPROVED BY<br>PDS |
| DATE<br>05/15/2024 |                    |
| JOB No. : 2300452  |                    |

**CALL TWO BUSINESS DAYS BEFORE YOU DIG**  
1-800-424-5555

**kpff**  
1601 5th Avenue, Suite 1600  
Seattle, WA 98101  
206.622.5822  
www.kpff.com

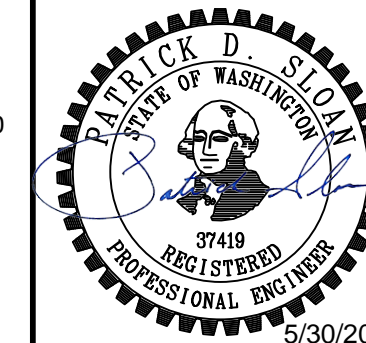

**ADA TRANSITION PLAN IMPLEMENTATION**  
MERCER ISLAND, WA

**DETAILS**

SHEET

**CD01**